

Bestchamte Lighting Limited

3/F, #C Building, GaoPu Industrial Districts, JiaoXin, Shijing, Baiyun, Guangzhou

TEL : +86-20-29052212

Mobile: +86-18620504633

Email : manager@bestchamte.net

Website: www.bestchamte.com

LED SCREENS INTRODUCTION



Control Card



LED Module



Cables



Power Supply



Aviation Plug

PRODUCTION PROCESS



1. Material Inspection



2. LED SMT



3. Wave Solder



4. Module Aging



7. Packing And Delivery



6. Display Aging Test



5. Cabinet Assembling



Package

CARTON PACKING



WOODEN CASE PACKING



FLIGHT CASE PACKING



How to control LED display?

By computer, wifi, 4G, usb, remote, internet, mobile, pad, etc. Yes, you can control in your convenient management. Many screens together? No problem, your laptop can manage all of them whenever and wherever.

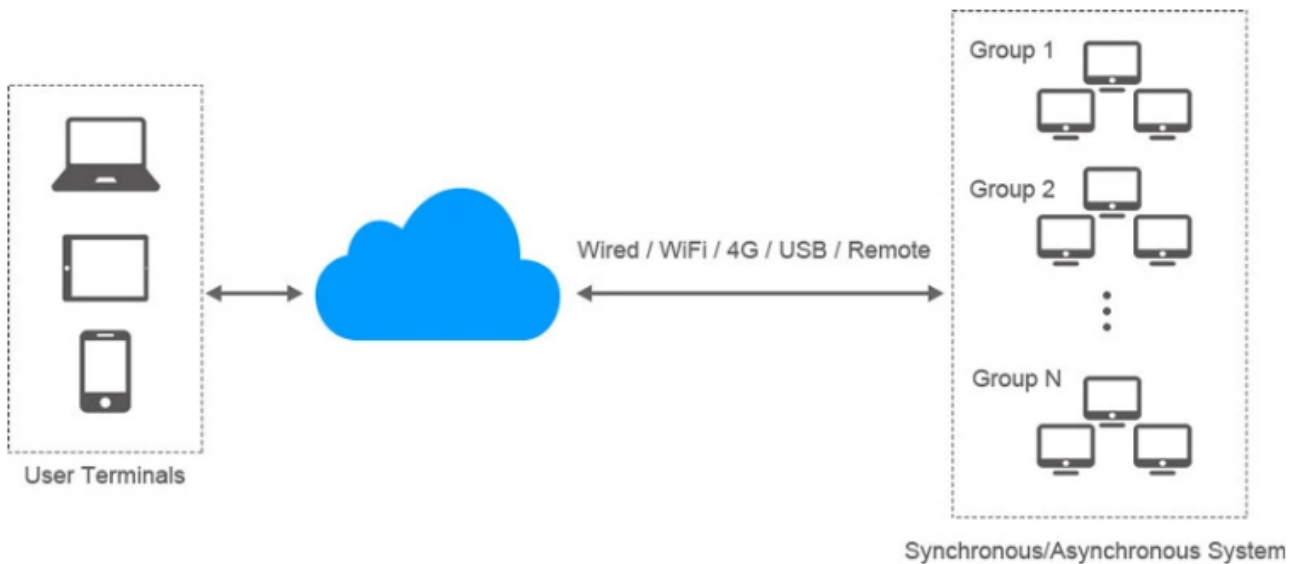

Connection System Diagram:

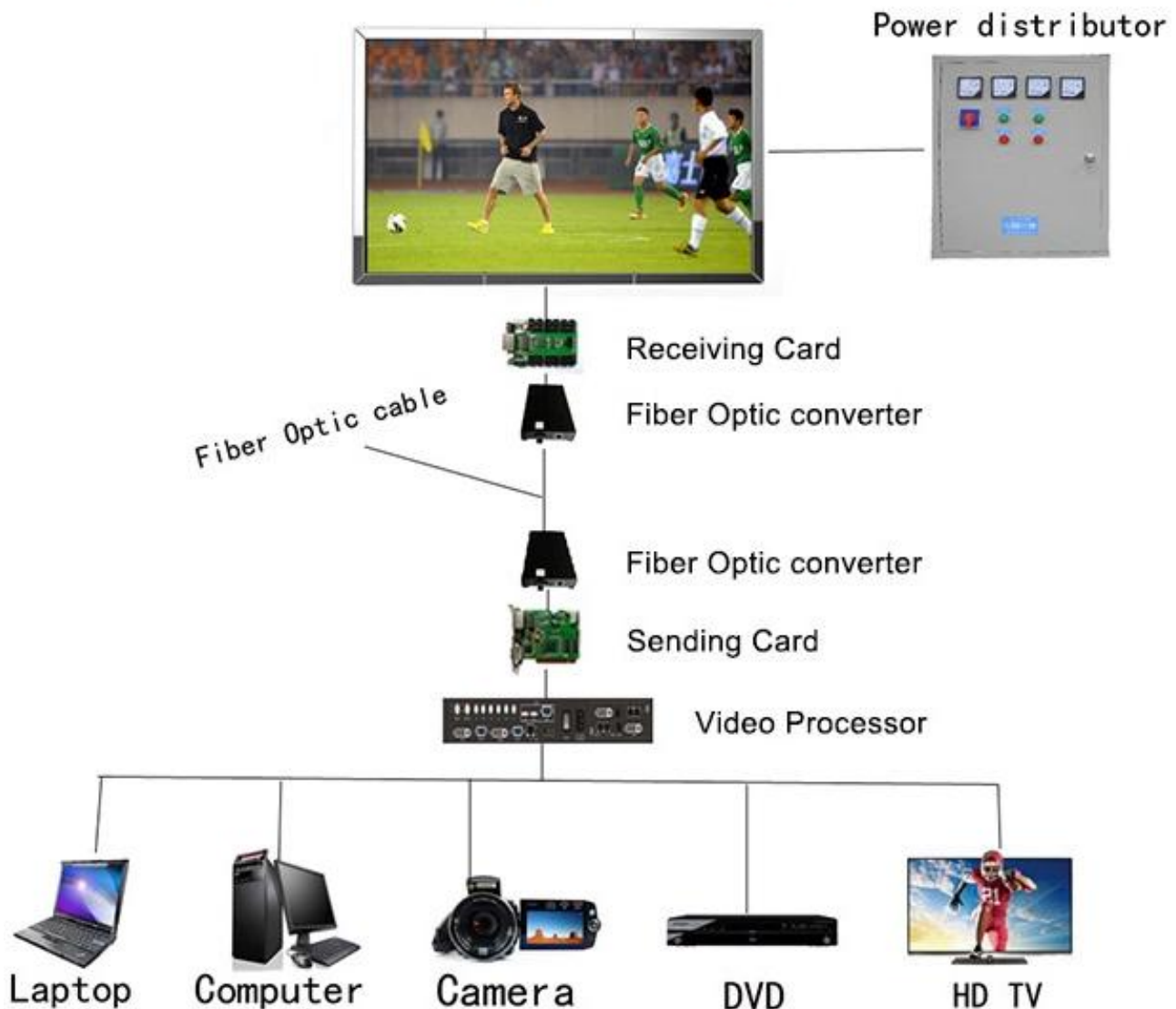

Various Shaped LED Display

Cylinder LED display, Curved LED display, 90 degrees LED display, Round LED display, LED ball, etc.

LEDFUL supply more design and more solutions.

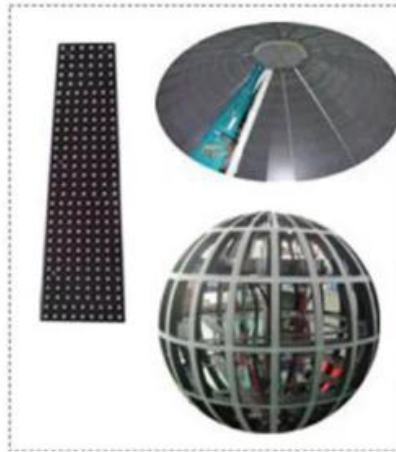

Pillar / Pole LED display

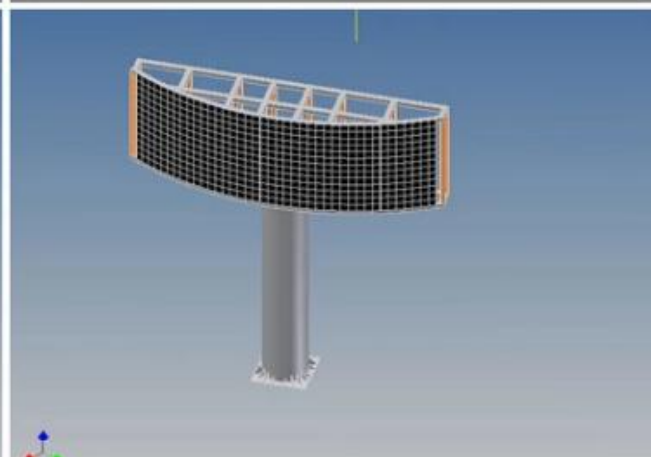
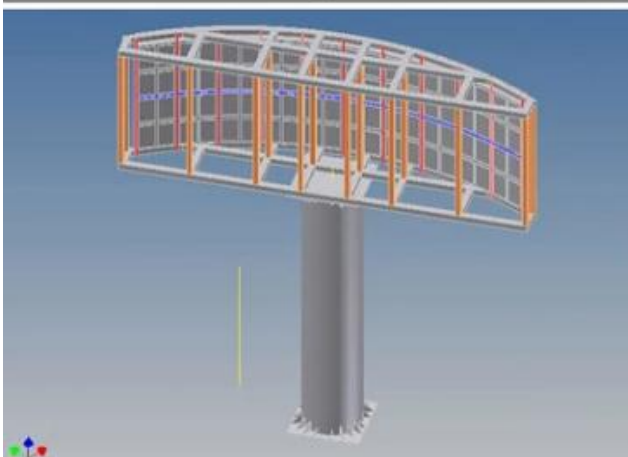
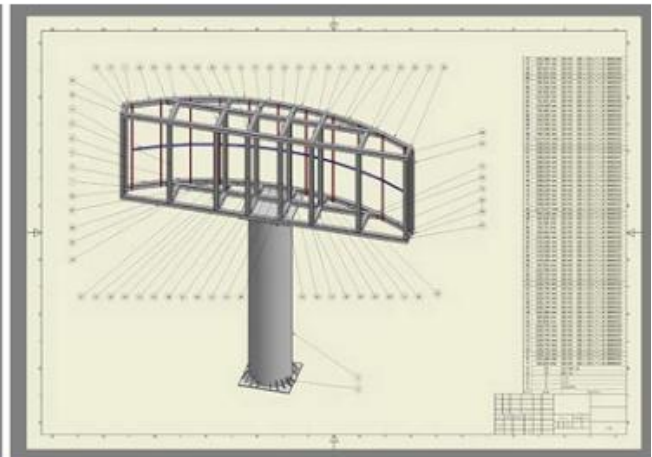
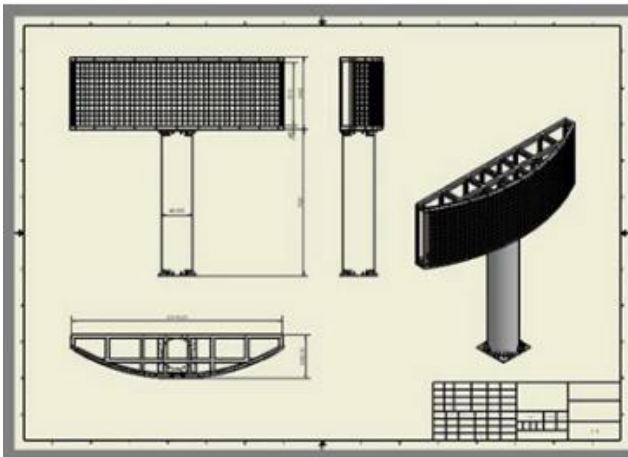

Wall mounted LED display

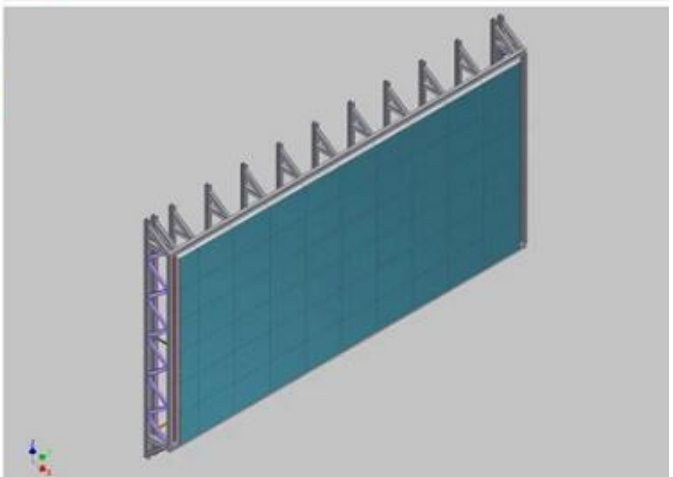
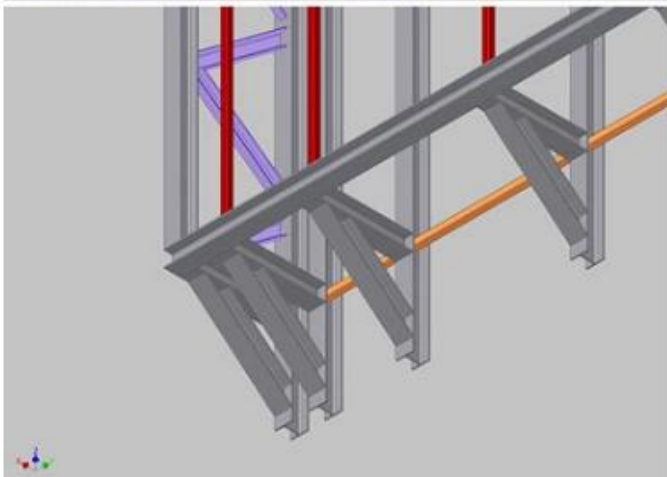
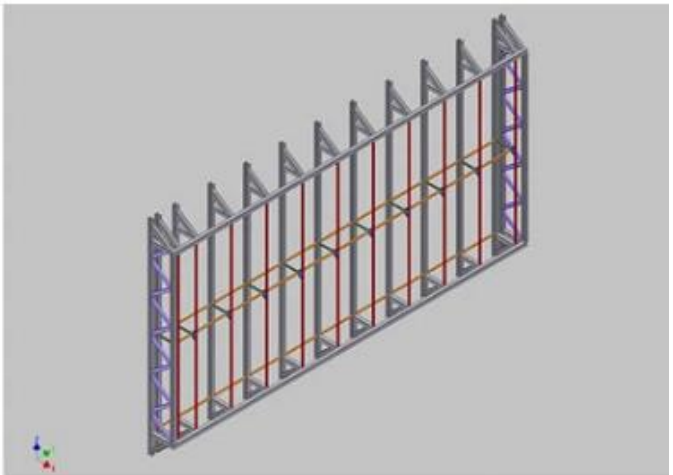
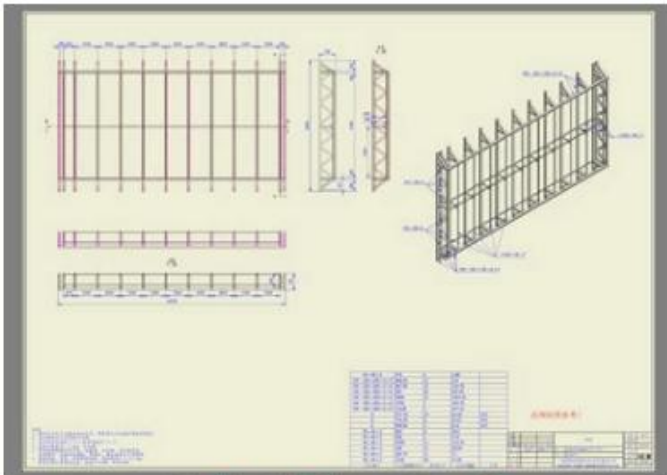

Hanging installation



Stacking installation

Flat Panel, Curve And Corner Panel Optional

CURVE DESIGN

- More options for your stage design(optional).

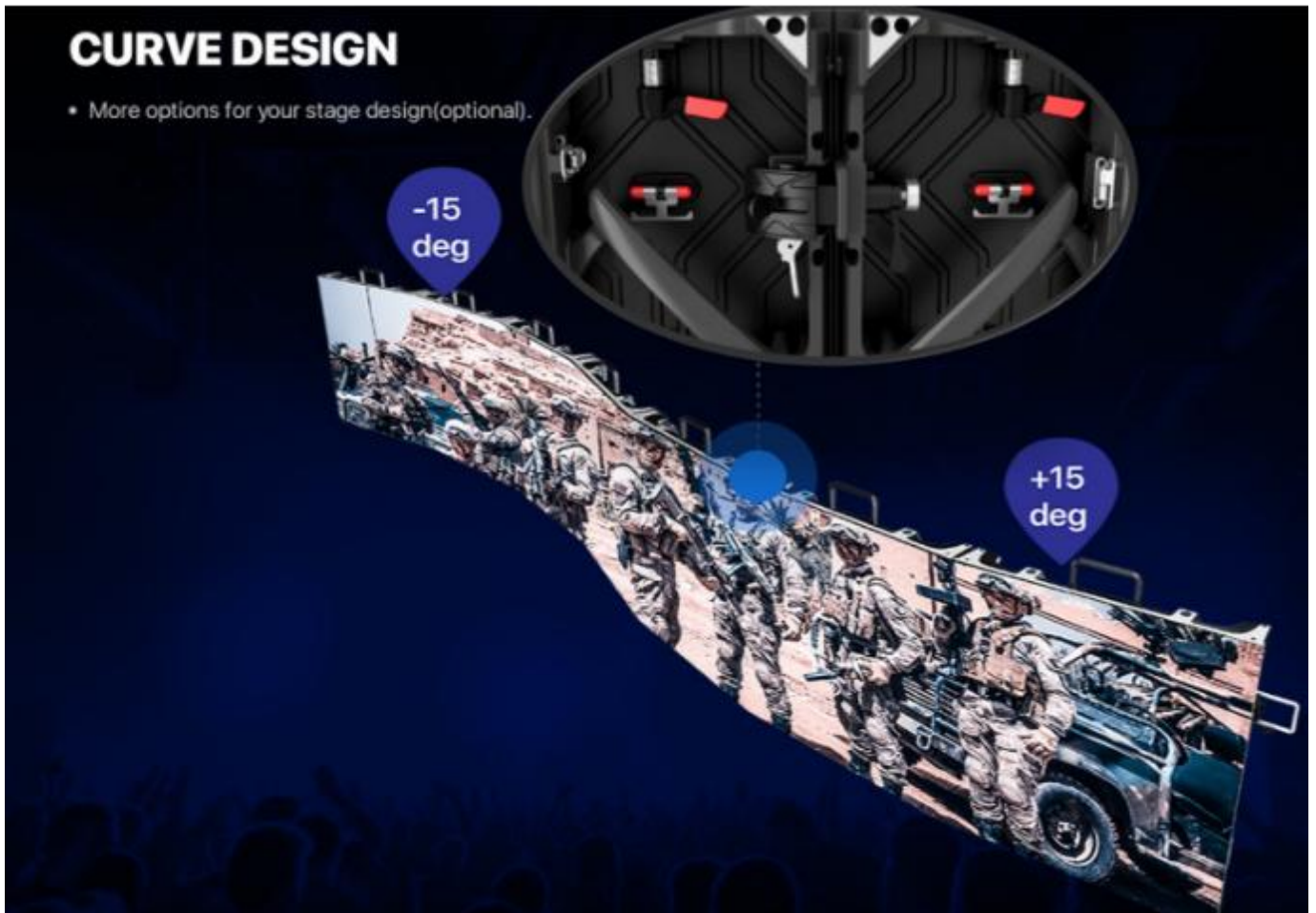

SMD Performance and View Angle

Better contrast ratio and viewing performance Wide viewing angle increasing its value by covering more viewing.



Project Cases

Outdoor fixed installation led wall display application cases



P6 outdoor 60x8m



P8 outdoor 10x4m

Indoor fixed installation led display wall application cases



P3 indoor 8x4m



P2 indoor 8x4m

Outdoor rental led wall display application cases



P4.81 outdoor 8x5m



P5 outdoor 4x2.5m

Indoor rental led display wall application cases



P3.91 indoor 10x4m



P4.81 indoor 25x8m

Outdoor mobile led wall display application cases



P3.91 outdoor 4x2.5m



P3.91 outdoor 4x2.5m

Flexibly curved led wall display application cases



P10 outdoor 50x8m



P2.5 indoor 15x0.48m

Transparent led display application cases



P3.91-7.82 60 m²



P3.91-7.82 30 m²

LED poster display application cases



P2.5 LED Poster Display



P2.5 LED Poster Display

INDOOR LED SCREENS



SMD 3 in 1



LED Module

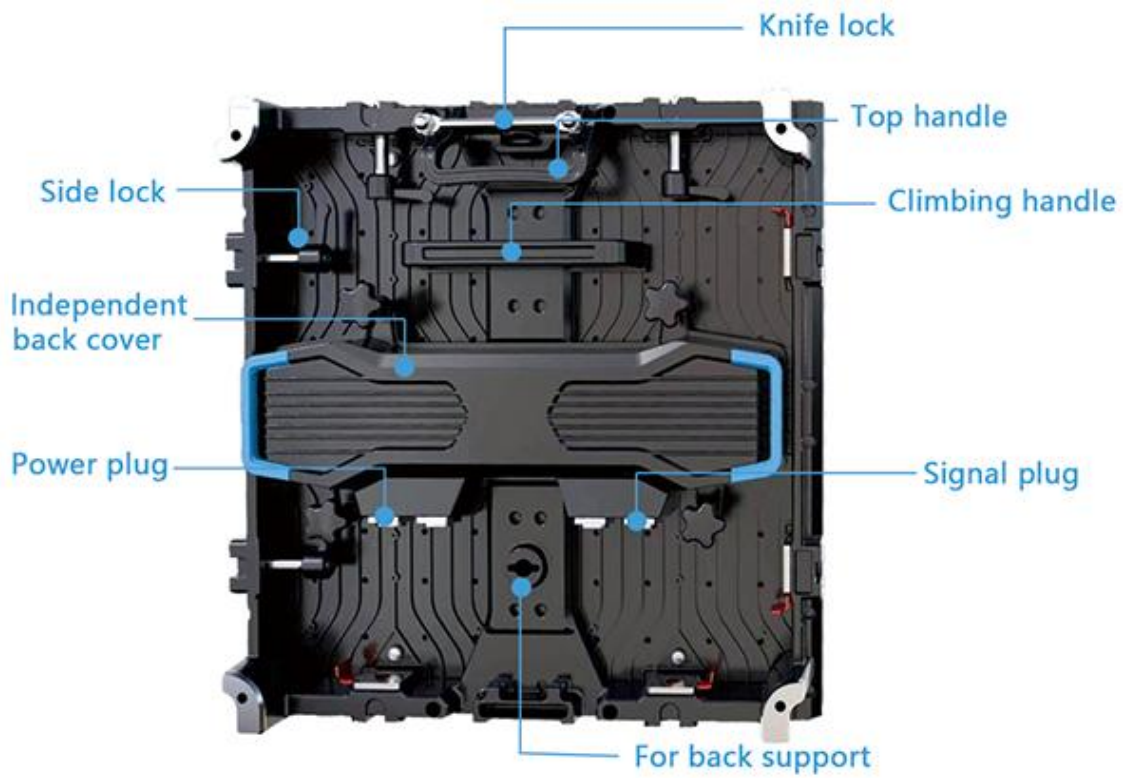

References

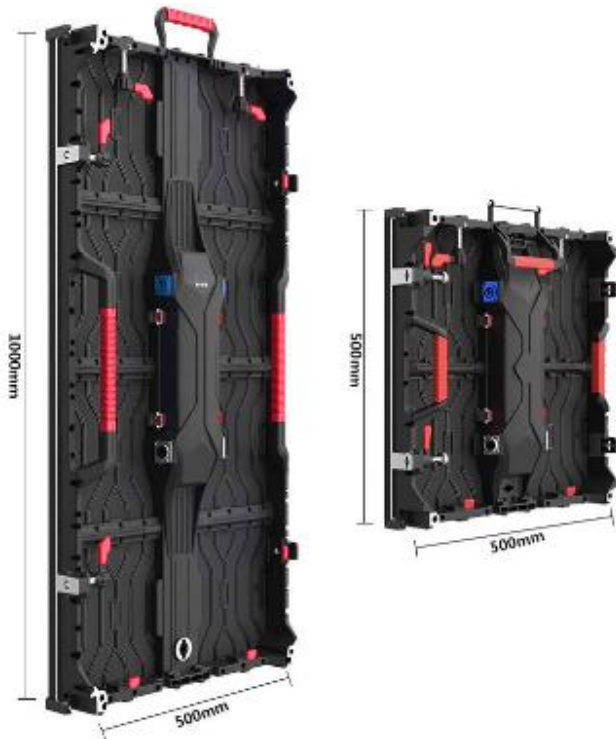

Pixel Pitch: 4.81mm
 Pixel Density: 43264dots/sqm
 Color Configuration: 1R1G1B
 LED Modele: SMD2121
 Module Size: 250mm x 250mm
 Module Resolution: 52dots x 52dots
 Drive Mode: 1/13 Scan
 Cabinet Material: Die casting Aluminum
 Led Color: Black
 Standard Cabinet Size: 50 x 50CM/ 50 x 100CM
 Cabinet Weight: 14KG /7KG
 Brightness: ≥ 1200 cd/sqm, adjustable
 Viewing Distance: 4m-40m
 Viewing Angle: H: 160°; V:120°
 Refresh Rate: 3840HZ, adjustable
 Frame Rate: 120frame/s
 Grey Scale: 16.7M colors(Synchronized)
 Power Input: AC110V/ 220V ± 10 , 50HZ
 Max Power Consumption: 800W/sqm
 Ave. Power Consumption: 300W/sqm
 Storage Temperature: - 35 °C ~ + 85 °C
 Working Temperature: - 20 °C ~ + 65 °C
 Blind Spot Rate: <1/10000
 MTBF: >10,000 Hours
 Life Span: >100,000 Hours
 Waterproof Level: IP43

INDOOR RENTAL LED SCREEN P4.81

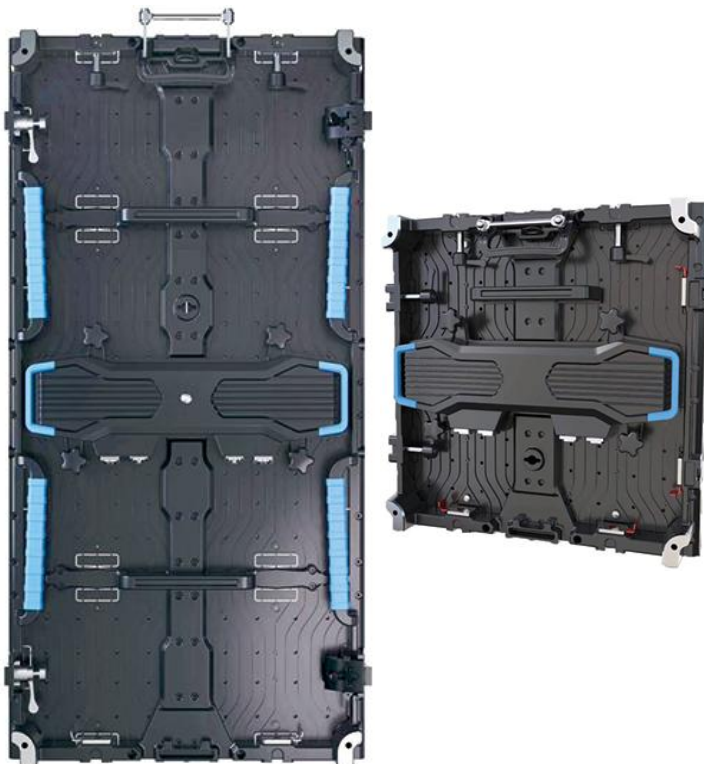

Pixel Pitch: 3.91mm
 Pixel Density: 65536dots/sqm
 Color Configuration: 1R1G1B
 LED Modele: SMD2121
 Module Size: 250mm x 250mm
 Module Resolution: 64dots x 64dots
 Drive Mode: 1/16 Scan
 Cabinet Material: Die casting Aluminum
 Led Color: Black
 Standard Cabinet Size: 50 x 50CM/ 50 x 100CM
 Cabinet Weight: 14KG /7KG
 Brightness: ≥ 1300 cd/sqm, adjustable
 Viewing Distance: 4m-40m
 Viewing Angle: H: 140°; V:120°
 Refresh Rate: 1500HZ, adjustable
 Frame Rate: 120frame/s
 Grey Scale: 16.7M colors(Synchronized)
 Power Input: AC110V/ 220V ± 10 , 50HZ
 Max Power Consumption: 800W/sqm
 Ave. Power Consumption: 300W/sqm
 Storage Temperature: - 35 °C ~ + 85 °C
 Working Temperature: - 20 °C ~ + 65 °C
 Blind Spot Rate: <1/10000
 MTBF: >10,000 Hours
 Life Span: >100,000 Hours
 Waterproof Level: IP43

INDOOR RENTAL LED SCREEN P3.91



Pixel Pitch: 2.976mm
 Pixel Density: 112896dots/sqm
 Color Configuration: 1R1G1B
 LED Modele: SMD3IN1
 Module Size: 250mm x 250mm
 Module Resolution: 84dots x 44dots
 Drive Mode: 1/16 Scan
 Cabinet Material: Die casting Aluminum
 Led Color: Black
 Standard Cabinet Size: 50 x 50CM/ 50 x 100CM
 Cabinet Weight: 14KG /7KG
 Brightness: ≥ 1300 cd/sqm, adjustable
 Viewing Distance: 2m-30m
 Viewing Angle: H: 140 °; V:120 °
 Refresh Rate: 1500HZ, adjustable
 Frame Rate: 120frame/s
 Grey Scale: 16.7M colors(Synchronized)
 Power Input: AC110V/ 220V ± 10 , 50HZ
 Max Power Consumption: 800W/sqm
 Ave. Power Consumption: 300W/sqm
 Storage Temperature: - 35 °C ~ + 85 °C
 Working Temperature: - 20 °C ~ + 65 °C
 Blind Spot Rate: <1/10000
 MTBF: >10,000 Hours
 Life Span: >100,000 Hours
 Waterproof Level: IP43

INDOOR RENTAL LED SCREEN P2.976



Pixel Pitch: 5mm
 Pixel Density: 40000dots/sqm
 Color Configuration: 1R1G1B
 LED Modele: SMD2121
 Module Size: 320mm x 160mm
 Drive Mode: 1/8 Scan
 Cabinet Material: Die casting Aluminum
 Led Color: Black
 Standard Cabinet Size: 960 x 960mm
 Cabinet Weight: 12KG
 Brightness: ≥ 1200 cd/sqm, adjustable
 Viewing Distance: 5m-50m
 Viewing Angle: H: 140 °; V:140 °
 Refresh Rate: 1920HZ, adjustable
 Frame Rate: 120frame/s
 Grey Scale: 16.7M colors(Synchronized)
 Power Input: AC110V/ 220V ± 10 , 50HZ
 Max Power Consumption: 800W/sqm
 Ave. Power Consumption: 300W/sqm
 Storage Temperature: - 30 °C ~ + 70 °C
 Working Temperature: - 20 °C ~ + 50 °C
 Blind Spot Rate: <1/10000
 MTBF: >10,000 Hours
 Life Span: >100,000 Hours
 Waterproof Level: IP43

INDOOR LED SCREEN P5



INDOOR LED SCREEN P4

Pixel Pitch: 4mm
 Pixel Density: 62500dots/sqm
 Color Configuration: 1R1G1B
 LED Modele: SMD2121
 Module Size: 256mm x 128mm
 Drive Mode: 1/16 Scan
 Cabinet Material: Die casting Aluminum
 Led Color: Black
 Standard Cabinet Size: 512 x 512mm
 Cabinet Weight: 7KG
 Brightness: ≥ 1500 cd/sqm, adjustable
 Viewing Distance: 3m-40m
 Viewing Angle: H: 120 °, V:120 °
 Refresh Rate: 1920HZ, adjustable
 Frame Rate: 120frame/s
 Grey Scale: 16.7M colors(Synchronized)
 Power Input: AC110V/ 220V ± 10 , 50HZ
 Max Power Consumption: 900W/sqm
 Ave. Power Consumption: 300W/sqm
 Storage Temperature: - 35 °C ~ + 85 °C
 Working Temperature: - 20 °C ~ + 65 °C
 Blind Spot Rate: <1/10000
 MTBF: >10,000 Hours
 Life Span: >100,000 Hours
 Waterproof Level: IP43



INDOOR LED SCREEN P3

Pixel Pitch: 3mm
 Pixel Density: 111111dots/sqm
 Color Configuration: 1R1G1B
 LED Modele: SMD2121
 Module Size: 192mm x 192mm
 Drive Mode: 1/32 Scan
 Cabinet Material: Die casting Aluminum
 Led Color: Black
 Standard Cabinet Size: 576 x 576mm
 Cabinet Weight: 8KG
 Brightness: ≥ 1200 cd/sqm, adjustable
 Viewing Distance: 3m-30m
 Viewing Angle: H: 140 °, V:140 °
 Refresh Rate: 3840HZ, adjustable
 Frame Rate: 120frame/s
 Grey Scale: 16.7M colors(Synchronized)
 Power Input: AC110V/ 220V ± 10 , 50HZ
 Max Power Consumption: 1000W/sqm
 Ave. Power Consumption: 300W/sqm
 Storage Temperature: - 30 °C ~ + 70 °C
 Working Temperature: - 20 °C ~ + 50 °C
 Blind Spot Rate: <1/10000
 MTBF: >10,000 Hours
 Life Span: >100,000 Hours
 Waterproof Level: IP43



Pixel Pitch: 2.5mm
 Pixel Density: 160000dots/sqm
 Color Configuration: 1R1G1B
 LED Modele: SMD2121
 Module Size: 160mm x 160mm
 Drive Mode: 1/32 Scan
 Cabinet Material: Die casting Aluminum
 Led Color: Black
 Standard Cabinet Size: 640 x 640mm
 Cabinet Weight: 12KG
 Brightness: ≥ 1200 cd/sqm, adjustable
 Viewing Distance: 2.5m-30m
 Viewing Angle: H: 140 °; V:140 °
 Refresh Rate: 2000HZ, adjustable
 Frame Rate: 120frame/s
 Grey Scale: 16.7M colors(Synchronized)
 Power Input: AC110V/ 220V ± 10 , 50HZ
 Max Power Consumption: 850W/sqm
 Ave. Power Consumption: 350W/sqm
 Storage Temperature: - 35 °C ~ + 85 °C
 Working Temperature: - 20 °C ~ + 65 °C
 Blind Spot Rate: <1/10000
 MTBF: >10,000 Hours
 Life Span: >100,000 Hours
 Waterproof Level: IP43

INDOOR RENTAL LED SCREEN P2.5



Pixel Pitch: 2mm
 Pixel Density: 250000dots/sqm
 Color Configuration: 1R1G1B
 LED Modele: SMD1515
 Module Size: 256mm x 128mm
 Drive Mode: 1/32 Scan
 Cabinet Material: Die casting Aluminum
 Led Color: Black
 Standard Cabinet Size: 512 x 512mm
 Cabinet Weight: 7KG
 Brightness: ≥ 800 cd/sqm, adjustable
 Viewing Distance: 2m-30m
 Viewing Angle: H: 140 °; V:140 °
 Refresh Rate: 1920HZ, adjustable
 Frame Rate: 120frame/s
 Grey Scale: 16.7M colors(Synchronized)
 Power Input: AC110V/ 220V ± 10 , 50HZ
 Max Power Consumption: 700W/sqm
 Ave. Power Consumption: 300W/sqm
 Storage Temperature: - 30 °C ~ + 70 °C
 Working Temperature: - 20 °C ~ + 50 °C
 Blind Spot Rate: <1/10000
 MTBF: >10,000 Hours
 Life Span: >100,000 Hours
 Waterproof Level: IP43

INDOOR RENTAL LED SCREEN P2

OUTDOOR LED SCREENS



SMD 3 in 1



Module



References



Pixel Pitch: 2.5mm
 Pixel Density: 160000dots/sqm
 Color Configuration: 1R1G1B
 LED Modele: SMD3IN1
 Module Size: 160mm x 160mm
 Module Resolution: 84dots x 44dots
 Drive Mode: 1/16 Scan
 Cabinet Material: Die casting Aluminum
 Led Color: Black
 Standard Cabinet Size: 640 x 640mm
 Cabinet Weight: 14KG
 Brightness: ≥ 1500 cd/sqm, adjustable
 Viewing Distance: 2m-50m
 Viewing Angle: H: 140 °; V:120 °
 Refresh Rate: 3840HZ, adjustable
 Frame Rate: 120frame/s
 Grey Scale: 16.7M colors(Synchronized)
 Power Input: AC110V/ 220V ± 10 , 50HZ
 Max Power Consumption: 800W/sqm
 Ave. Power Consumption: 400W/sqm
 Storage Temperature: - 35 °C ~ + 85 °C
 Working Temperature: - 20 °C ~ + 65 °C
 Blind Spot Rate: <1/10000
 MTBF: >10,000 Hours
 Life Span: >100,000 Hours
 Waterproof Level: IP43

OUTDOOR LED SCREEN P2.5



Pixel Pitch: 2.976mm
 Pixel Density: 112896dots/sqm
 Color Configuration: 1R1G1B
 LED Modele: SMD2727
 Module Size: 250mm x 250mm
 Module Resolution: 64dots x 64dots
 Drive Mode: 1/16 Scan
 Cabinet Material: Die casting Aluminum
 Standard Cabinet Size: 50 x 50CM/ 50 x 100CM
 Cabinet Weight: 12KG /7KG
 Brightness: ≥ 1500 cd/sqm, adjustable
 Viewing Distance: 3m-40m
 Viewing Angle: H: 140 °; V:120 °
 Refresh Rate: 1920HZ, adjustable
 Frame Rate: 120frame/s
 Grey Scale: 16.7M colors(Synchronized)
 Power Input: AC110V/ 220V ± 10 , 50HZ
 Max Power Consumption: 800W/sqm
 Color Temperature: R.G.B brightness 256 level adjustable
 Working Temperature: - 30 °C ~ + 60 °C
 Blind Spot Rate: <1/10000
 MTBF: >10,000 Hours
 Life Span: >100,000 Hours
 Waterproof Level: IP65

OUTDOOR RENTAL LED SCREEN P2.976

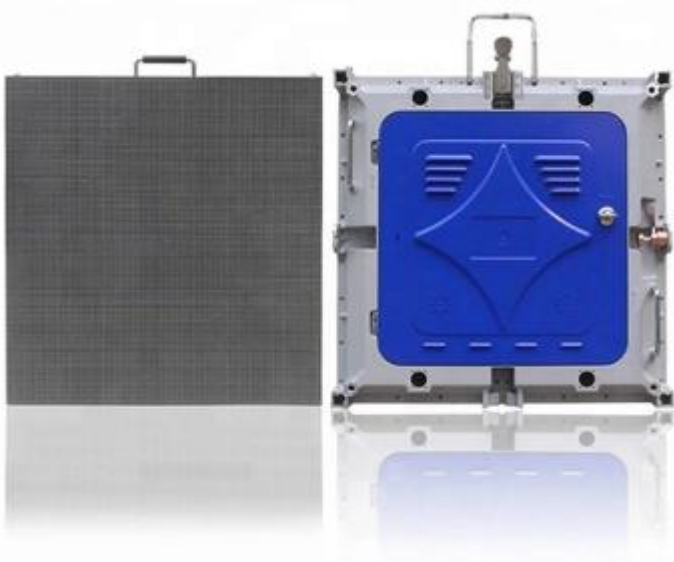

Pixel Pitch: 3mm
 Pixel Density: 111111dots/sqm
 Color Configuration: 1R1G1B
 LED Modele: SMD1921
 Module Size: 192mm x 192mm
 Drive Mode: 1/16 Scan
 Cabinet Material: Die casting Aluminum
 Led Color: Black
 Standard Cabinet Size: 768 x 768mm
 Cabinet Weight: 13KG
 Brightness: ≥ 1500 cd/sqm, adjustable
 Viewing Distance: 3m-30m
 Viewing Angle: H: 140 °, V:140 °
 Refresh Rate: 1920HZ, adjustable
 Frame Rate: 120frame/s
 Grey Scale: 16.7M colors(Synchronized)
 Power Input: AC110V/ 220V ± 10 , 50HZ
 Max Power Consumption: 900W/sqm
 Ave. Power Consumption: 300W/sqm
 Storage Temperature: - 30 °C ~ + 70 °C
 Working Temperature: - 20 °C ~ + 50 °C

OUTDOOR LED SCREEN P3

Blind Spot Rate: <1/10000
 MTBF: >10,000 Hours
 Life Span: >100,000 Hours
 Waterproof Level: IP65



Pixel Pitch: 3.91mm
 Pixel Density: 65410dots/sqm
 Color Configuration: 1R1G1B
 LED Modele: SMD1921
 Module Size: 128mm x 128mm
 Module Resolution: 128x256 pixels
 Drive Mode: 1/16 Scan
 Cabinet Material: Die casting Aluminum
 Standard Cabinet Size: 50 x 50CM/ 50 x 100CM
 Cabinet Weight: 12KG /7KG
 Brightness: ≥ 1300 cd/sqm, adjustable
 Viewing Distance: 3m-40m
 Viewing Angle: H: 120 °, V:120 °
 Refresh Rate: 3840HZ, adjustable
 Frame Rate: 120frame/s
 Grey Scale: 16.7M colors(Synchronized)
 Power Input: AC110V/ 220V ± 10 , 50HZ
 Max Power Consumption: 800W/sqm
 Color Temperature: R.G.B brightness 256 level adjustable

OUTDOOR RENTAL LED SCREEN P3.91

Working Temperature: - 30 °C ~ + 60 °C
 Blind Spot Rate: <1/10000
 MTBF: >10,000 Hours
 Life Span: >100,000 Hours
 Waterproof Level: IP65



Pixel Pitch: 4.81mm
 Pixel Density: 43264dots/sqm
 Color Configuration: 1R1G1B
 LED Modele: SMD2727
 Module Size: 250mm x 250mm
 Module Resolution: 104x208 pixels
 Drive Mode: 1/16 Scan
 Cabinet Material: Die casting Aluminum
 Standard Cabinet Size: 50 x 50CM/ 50 x 100CM
 Cabinet Weight: 12KG /7KG
 Brightness: ≥ 1500 nits
 Viewing Distance: 5m-40m
 Viewing Angle: H: 120 °, V:120 °
 Refresh Rate: 1920HZ, adjustable
 Frame Rate: 120frame/s
 Grey Scale: 16.7M colors(Synchronized)
 Power Input: AC110V/ 220V ± 10 , 50HZ
 Max Power Consumption: 800W/sqm
 Color Temperature: R.G.B brightness 256 level adjustable

OUTDOOR RENTAL LED SCREEN P4.81

Working Temperature: - 30 °C ~ + 60 °C
 Blind Spot Rate: <1/10000
 MTBF: >10,000 Hours
 Life Span: >100,000 Hours
 Waterproof Level: IP65



Pixel Pitch: 4mm
 Pixel Density: 62500dots/sqm
 Color Configuration: 1R1G1B
 LED Modele: SMD2727
 Module Size: 256mm x 128mm
 Drive Mode: 1/16 Scan
 Cabinet Material: Die casting Aluminum
 Led Color: Black
 Standard Cabinet Size: 768 x 768mm
 Cabinet Weight: 13KG
 Brightness: ≥ 1500 cd/sqm, adjustable
 Viewing Distance: 3m-40m
 Viewing Angle: H: 140 °, V:140 °
 Refresh Rate: 1920HZ, adjustable
 Frame Rate: 120frame/s
 Grey Scale: 16.7M colors(Synchronized)
 Power Input: AC110V/ 220V ± 10 , 50HZ
 Max Power Consumption: 900W/sqm
 Ave. Power Consumption: 300W/sqm
 Storage Temperature: - 30 °C ~ + 70 °C

OUTDOOR LED SCREEN P4

Working Temperature: - 20 °C ~ + 50 °C
 Blind Spot Rate: <1/10000
 MTBF: >10,000 Hours
 Life Span: >100,000 Hours
 Waterproof Level: IP65

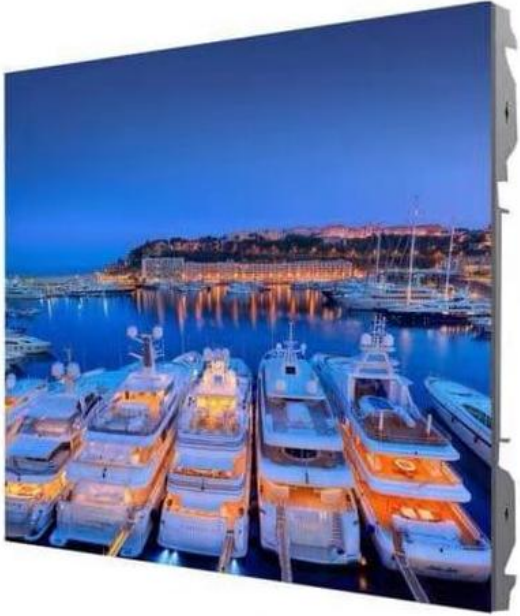

OUTDOOR LED SCREEN P5

Pixel Pitch: 5mm
 Pixel Density: 40000dots/sqm
 Color Configuration: 1R1G1B
 LED Modele: SMD2727
 Module Size: 160mm x 160mm
 Drive Mode: 1/8 Scan
 Cabinet Material: Die casting Aluminum
 Led Color: Black
 Standard Cabinet Size: 960 x 960mm
 Cabinet Weight: 13KG
 Brightness: ≥ 1200 cd/sqm, adjustable
 Viewing Distance: 5m-50m
 Viewing Angle: H: 140 °, V:140 °
 Refresh Rate: 1920HZ, adjustable
 Frame Rate: 120frame/s
 Grey Scale: 16.7M colors(Synchronized)
 Power Input: AC110V/ 220V ± 10 , 50HZ
 Max Power Consumption: 800W/sqm
 Ave. Power Consumption: 300W/sqm
 Storage Temperature: - 30 °C ~ + 70 °C
 Working Temperature: - 20 °C ~ + 50 °C
 Blind Spot Rate: <1/10000
 MTBF: >10,000 Hours
 Life Span: >100,000 Hours
 Waterproof Level: IP65



OUTDOOR LED SCREEN P6

Pixel Pitch: 6mm
 Pixel Density: 27777dots/sqm
 Color Configuration: 1R1G1B
 LED Modele: SMD1921
 Module Size: 192mm x 192mm
 Drive Mode: 1/4 Scan
 Cabinet Material: Die casting Aluminum
 Led Color: Black
 Standard Cabinet Size: 768 x 768mm
 Cabinet Weight: 13KG
 Brightness: ≥ 1500 cd/sqm, adjustable
 Viewing Distance: 3m-30m
 Viewing Angle: H: 140 °, V:140 °
 Refresh Rate: 1920HZ, adjustable
 Frame Rate: 120frame/s
 Grey Scale: 16.7M colors(Synchronized)
 Power Input: AC110V/ 220V ± 10 , 50HZ
 Max Power Consumption: 900W/sqm
 Ave. Power Consumption: 300W/sqm
 Storage Temperature: - 30 °C ~ + 70 °C
 Working Temperature: - 20 °C ~ + 50 °C
 Blind Spot Rate: <1/10000
 MTBF: >10,000 Hours
 Life Span: >100,000 Hours
 Waterproof Level: IP65



OUTDOOR LED SCREEN P8

Pixel Pitch: 8mm
 Pixel Density: 15625dots/sqm
 Color Configuration: 1R1G1B
 LED Modele: SMD1921
 Module Size: 256mm x 128mm
 Drive Mode: 1/4 Scan
 Cabinet Material: Die casting Aluminum
 Led Color: Black
 Standard Cabinet Size: 768 x 768mm
 Cabinet Weight: 13KG
 Brightness: ≥ 1500 cd/sqm, adjustable
 Viewing Distance: 3m-30m
 Viewing Angle: H: 140 °, V:140 °
 Refresh Rate: 1920HZ, adjustable
 Frame Rate: 120frame/s
 Grey Scale: 16.7M colors(Synchronized)
 Power Input: AC110V/ 220V ± 10 , 50HZ
 Max Power Consumption: 900W/sqm
 Ave. Power Consumption: 300W/sqm
 Storage Temperature: - 30 °C ~ + 70 °C
 Working Temperature: - 20 °C ~ + 50 °C
 Blind Spot Rate: <1/10000
 MTBF: >10,000 Hours
 Life Span: >100,000 Hours
 Waterproof Level: IP65



OUTDOOR LED SCREEN P10

Pixel Pitch: 10mm
 Pixel Density: 10000dots/sqm
 Color Configuration: 1R1G1B
 LED Modele: SMD3535
 Module Size: 320mm x 160mm
 Drive Mode: 1/2 Scan
 Cabinet Material: Die casting Aluminum
 Led Color: Black
 Standard Cabinet Size: 960 x 960mm
 Cabinet Weight: 28KG
 Brightness: ≥ 1500 cd/sqm, adjustable
 Viewing Distance: 10m-100m
 Viewing Angle: H: 140 °, V:140 °
 Refresh Rate: 1920HZ, adjustable
 Frame Rate: 120frame/s
 Grey Scale: 16.7M colors(Synchronized)
 Power Input: AC110V/ 220V ± 10 , 50HZ
 Max Power Consumption: 800W/sqm
 Ave. Power Consumption: 200W/sqm
 Storage Temperature: - 30 °C ~ + 70 °C
 Working Temperature: - 20 °C ~ + 50 °C
 Blind Spot Rate: <1/10000
 MTBF: >10,000 Hours
 Life Span: >100,000 Hours
 Waterproof Level: IP65